

SVGA Projector

Light, Bright, and Portable Projector

PJD5132



The ViewSonic® PJD5132 is a high-performance SVGA 800x600 DLP® projector with 3000 ANSI lumens and 15000:1 contrast ratio. With DynamicEco™ technology, presenters can put the projector in “standby” mode by reducing brightness down to 30% when they need to shift audience’s focus without restarting the projector. This projector offers a variety of hardware and software features including multiple PC and video input options, 1.1x optical zoom, keystone correction, PC 3D-ready/120Hz, support HD signal and integrated speaker. Filter-less design and energy-saving Eco-mode provide for easy maintenance and reliable product life. The PJD5132 lightweight design is ideal for tabletop use or ceiling mounting in both classrooms and corporate offices.

Bright in Virtually Any Setting

Packed with 3000 lumens and a high contrast ratio of 15,000:1 (with DynamicEco), your presentations are guaranteed to be vibrant even in the brightest office environments.

Reliable Picture Quality & Color Performance

ViewSonic DLP projectors provide reliable picture quality you can trust and superior color performance you can count on after thousands of hours of usage. Built on DLP technology, ViewSonic PJD5132 projector virtually eliminates image degradation known as color decay – yellow/faded tint that LCD projectors may develop after extended use. Even after years of use, the PJD5132 is still producing a stunning, sharp image that lasts.

Maintenance Free

ViewSonic PJD5132 projector enables a filter-less design. Unlike LCD projectors require to clean, sometimes to replace, filters after every 100 to 300 hours of operation, ViewSonic PJD5132 projector is filter-less that eliminates the need for filter cleaning or filter replacement. This saves you significant maintenance dollars and labor over the projector’s lifespan, and lowers your total cost of ownership (TCO).

Take Control of Audience’s Focus

With DynamicEco button on the remote, take command of presentations by dimming the screen image - up to 70%. The projector will also activate DynamicEco when the unit is not in use. When DynamicEco is activated, it greatly reduces the lamp power consumption – a great energy-saving design for low Total Cost of Ownership (TCO).

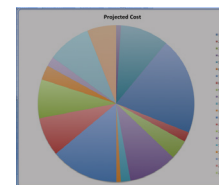

With DynamicEco™

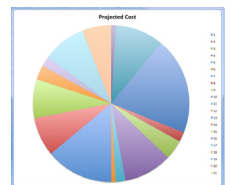

Without DynamicEco™

SVGA Projector

PJD5132



BrilliantColor™ Technology

ViewSonic PJD5132 projector with BrilliantColor technology features multi-color processing to produce stunning, vibrant colors. Unlike other technologies such as LCD which use just 3 primary colors to produce the image, the PJD5132 uses up to 6 separate colors. The sophisticated 6-segment color wheel enhances the yellow color performance that is the key to accurate and vivid color reproduction. With multi-color processing, colors are richer and more vibrant with exquisite and precise detail.



PC 3D-Ready / 120Hz Refresh Rate Powered DLP® Link Technology

With support for DLP® Link technology, you'll have amazing 3D capabilities at your disposal. All that's required to unlock 3D capabilities on ViewSonic PJD5132 3D-ready projector are ViewSonic PGD-250 3D active shutter glasses, 3D content and 3D-enabled video card. Unleash 3D experience with ViewSonic PJD5132 today.



Long Lamp Life up to 10,000 Hours

The new advanced lamp technology extends the lamp life up to 10,000 hours* and saves on maintenance costs.

Projection Distance		Screen Size (4:3) Diagonal	
Feet	Meters	Inches	Meters
3.6	1.1	30	0.8
9.8	3.0	80	2.0
14.8	4.5	120	3.0
18.7	5.7	150	3.8
24.6	7.5	200	5.1
30.8	9.4	250	6.4
37.1	11.3	300	7.6

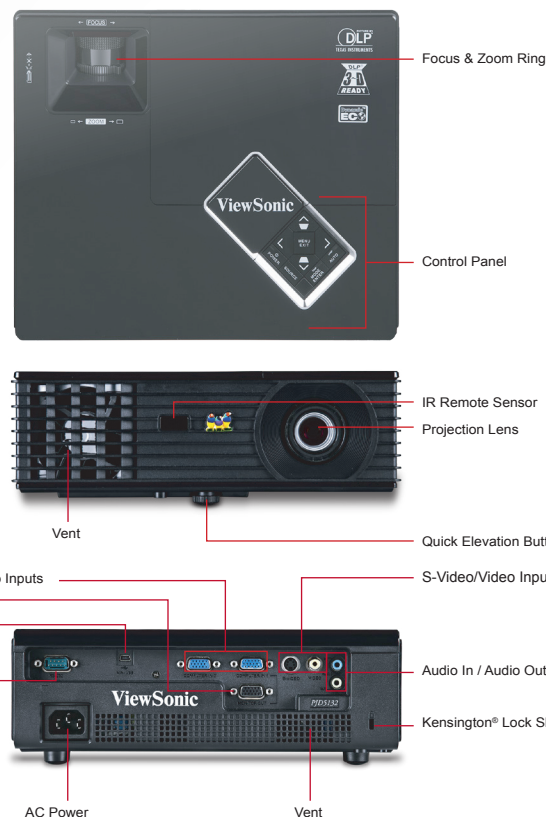

Specifications

DISPLAY	Type	0.55" Digital Micromirror Device (DLP™)
	Resolution	SVGA 800x600 (native)
	Lens	1.1x Manual optical zoom / manual optical focus
	Keystone	Vertical digital keystone correction (+/- 40°)
	Size	24 – 300 in. / 0.6 – 7.6 m (diagonal)
	Throw Distance	3.3 – 37.0 ft. / 1.0 – 11.3 m
	Throw Ratio	1.86~2.04:1
	Lamp	190 watt
	Lamp Life (Normal / DynamicEco)	4,500 / 10,000* hours
	Brightness	3000 Lumens
	Contrast Ratio	15,000:1 (w/ DynamicEco™)
	Aspect Ratio	4:3 (native)
	Color Depth	30 bits, 1.07B Color (10+10+10)
	Color Wheel	6-seg RGBCYW / 7200rpm
INPUT SIGNAL	Computer and Video	NTSC M (3.58 MHz), 4.43MHz, PAL (B, D, G, H, I, M, N, 60), SECAM (B, D, G, K, K1, L), SD 480i and 576i, ED 480p and 576p, HD 720p, 1080i, 1080p Fh: 31–100KHz, Fv: 48–120Hz
	Frequency	
COMPATIBILITY	PC Mac®	VGA to 1600x1200 UXGA Up to UXGA (may require MAC adaptor)
CONNECTOR	RGB Input	15-pin mini D-sub (x2)
	RGB Output	15-pin mini D-sub
	Component Input	15-pin mini D-sub (x2, shared with RGB)
	Composite Input	RCA jack
	S-Video	4-pin mini-DIN
	Audio Input	3.5mm mini jack
	Audio Output	3.5mm mini jack
	Control	RS-232 (DB-9)
	USB	Mini B (for mouse control and service)
AUDIO	Speaker	2W
POWER	Voltage	100–240VAC (Auto Switching), 50/60Hz (universal)
	Consumption	250W (typ) / <1W (stand-by mode)

CONTROLS	Basic	Power, keystone/arrow keys, left/blank, menu/exit, right/panel key lock, mode/enter, auto, source
	OSD	Display, Picture, Source, System Setup (Basic), System Setup (Advanced), Information (See user guide for full OSD functionality)
OPERATING CONDITIONS	Temperature	32°F–104°F (0°C–40°C)
	Humidity	10%–90% (non-condensing)
NOISE LEVEL	Altitude	0–6,000 ft (1,800m), operational up to 10,000 ft (3048m)
	Normal / Eco-mode	32dB / 29dB
DIMENSIONS (W x H x D)	Physical	10.6 x 3.3 x 8.7 in. / 268 x 84.4 x 221 mm
	Packaging	14.2 x 12.8 x 7.4 in. / 360 x 325 x 188 mm
WEIGHT	Net	4.6 lb. / 2.1 kg
	Gross	7.5 lb. / 3.4 kg
REGULATIONS		CB, UL, cUL, FCC (including ICES-003), CE, UL-Argentina, NOM, GS, GOST-R, SASO, Ukraine, PSB, C-Tick, Korean-KC, CCC, CECP, WEEE, RoHS

What's in the box?

PJD5132 projector, power cable, VGA cable, remote control with batteries, Quick Start Guide, ViewSonic Wizard DVD (with User Guide).

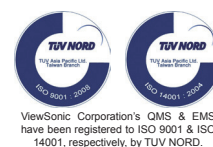

ViewSonic Corporation's QMS & EMS have been registered to ISO 9001 & ISO 14001, respectively, by TUV NORD.